

ROOM NAME	TOTAL SQ. FEET	DIMENSIONS	CEILING	THEATER	SCHOOLROOM	CONFERENCE	U-SHAPE	HOLLOW SQ.	RECEPTION	DINING	DINNER/DANCE
ONE LEVEL BELOW LOBBY											
PASADENA ROOM	25,116	182' X 138'	14'	1,900	850	-	-	-	2,000	1,500	1,300
PASADENA FOYER	4,300	-	-	-	-	-	-	-	-	-	-
PASADENA ROOM EXHIBIT BOOTH CAPACITIES ARE 161 8X10 AND 126 10X10											
LOBBY LEVEL											
SANTA ANITA	4,050	90' X 45'	9'6"	432	207	-	-	-	500	360	240
SANTA ANITA A & B	2,520	56' X 45'	9'6"	230	129	48	50	60	300	220	120
SANTA ANITA B & C	2,835	63' X 45'	9'6"	282	140	48	50	60	350	240	180
SANTA ANITA A	1,296	27' X 45'	9'6"	128	64	34	34	40	150	110	60
SANTA ANITA B	1,305	29' X 45'	9'6"	136	69	34	34	40	150	110	70
SANTA ANITA C	1,575	35' X 45'	9'6"	163	87	40	34	40	180	120	70
SAN GABRIEL	3,984	83' X 48'	10'	432	213	-	-	-	500	320	260
SAN GABRIEL A & B	2,736	57' X 48'	10'	250	153	48	50	60	350	220	120
SAN GABRIEL B & C	2,736	57' X 48'	10'	282	135	48	50	60	350	240	180
SAN GABRIEL A	1,248	26' X 48'	10'	128	64	34	34	40	150	110	60
SAN GABRIEL B	1,536	32' X 48'	10'	159	87	34	34	40	175	120	70
SAN GABRIEL C	1,200	25' X 48'	10'	128	69	34	34	40	175	120	70
SANTA BARBARA	3,652	83' X 44'	10'	390	195	-	-	-	450	310	240
SANTA BARBARA A & B	2,508	57' X 44'	10'	270	129	48	50	60	300	210	120
SANTA BARBARA B & C	2,552	58' X 44'	10'	270	132	48	50	60	300	210	120
SANTA BARBARA A	1,100	25' X 44'	10'	120	66	34	34	40	150	110	60
SANTA BARBARA B	1,408	32' X 44'	10'	144	69	34	34	40	180	120	70
SANTA BARBARA C	1,144	26' X 44'	10'	120	66	34	34	40	150	110	60
BEAUDRY A	1,718	57' X 29'	10'	180	90	-	-	-	200	120	-
BEAUDRY B	2,288	53' X 44'	10'	220	130	-	-	-	250	170	-
PALOS VERDES	1,365	39' X 35'	9'6"	122	72	34	27	40	150	110	80
SAN PEDRO	1,176	42' X 28'	10'	108	68	34	33	40	150	100	70
SAN FERNANDO	1,056	48' X 22'	8'6"	120	69	40	36	40	120	80	60
SAN BERNARDINO	986	34' X 29'	10'	108	68	34	33	40	150	100	70
LOS FELIZ	810	30' X 27'	10'	68	50	22	24	40	80	60	40
LOS CERRITOS	702	27' X 26'	10'	68	50	22	24	40	80	60	40
LA BREA	483	23' X 21'	10'	40	18	20	18	20	30	40	-
LA CIENEGA	391	23' X 17'	10'	30	18	20	18	20	30	30	-
LEVEL 2											
CALIFORNIA BALLROOM	26,108	214' X 122'	18'	3,000	1,656	-	-	-	3,000	2,350	2,000
SAN DIEGO, SAN JOSE & SAN FRAN.	20,252	166' X 122'	10' & 18'	2,055	1,164	-	-	-	2,300	1,700	1,300
SAN JOSE, SAN FRAN. & SACRAMENTO	19,276	158' X 122'	18'	2,227	1,032	-	-	-	2,200	1,550	1,300
SAN FRANCISCO & SACRAMENTO	13,786	113' X 122'	18'	1,505	800	-	-	-	1,500	1,100	860
SAN DIEGO & SAN JOSE	12,322	101' X 122'	10' & 18'	1,232	785	-	-	-	1,500	1,040	810
SAN FRANCISCO	7,930	65' X 122'	18'	767	369	-	-	-	800	520	380
SAN DIEGO	6,832	56' X 122'	10'	780	426	-	-	-	800	560	450
SACRAMENTO	5,856	48' X 122'	18'	660	378	-	-	-	700	480	360
SAN JOSE	5,490	45' X 122'	18'	464	312	-	-	-	600	440	320
CALIFORNIA FOYER	11,556	-	-	-	-	-	-	-	1,800	-	-
LEVEL 3											
CATALINA BALLROOM	8,190	130' X 63'	10'10"	980	501	-	-	-	1,000	660	550
AVALON	4,095	65' X 63'	10'10"	466	240	52	63	72	500	310	250
EMERALD BAY	4,095	65' X 63'	8'10"	466	240	52	63	72	500	310	250
CATALINA FOYER	2,016	-	-	-	-	-	-	-	-	-	-
HOLLYWOOD BALLROOM	4,750	50' X 92'	9'10"	400	200	40	40	60	500	400	300
SANTA MONICA A	1,075	24' X 42'	8'9"	90	50	30	25	60	30	80	60
SANTA MONICA B	1,147	48' X 25'	8'8"	110	60	35	30	60	35	100	90
SANTA MONICA C	800	25' X 36'	8'8"	60	44	20	20	35	25	50	40
SANTA MONICA D	948	41' X 17'	8'8"	60	40	25	25	50	30	60	50
INTERNATIONAL ROOM	1,486	46' X 56'	8'	-	-	-	-	-	-	-	-
LEVEL 4											
PLAZA POOL DECK	45,000	234' X 212'	-	-	-	-	-	-	3,000	1,200	-

one level below lobby – pasadena room exhibition hall

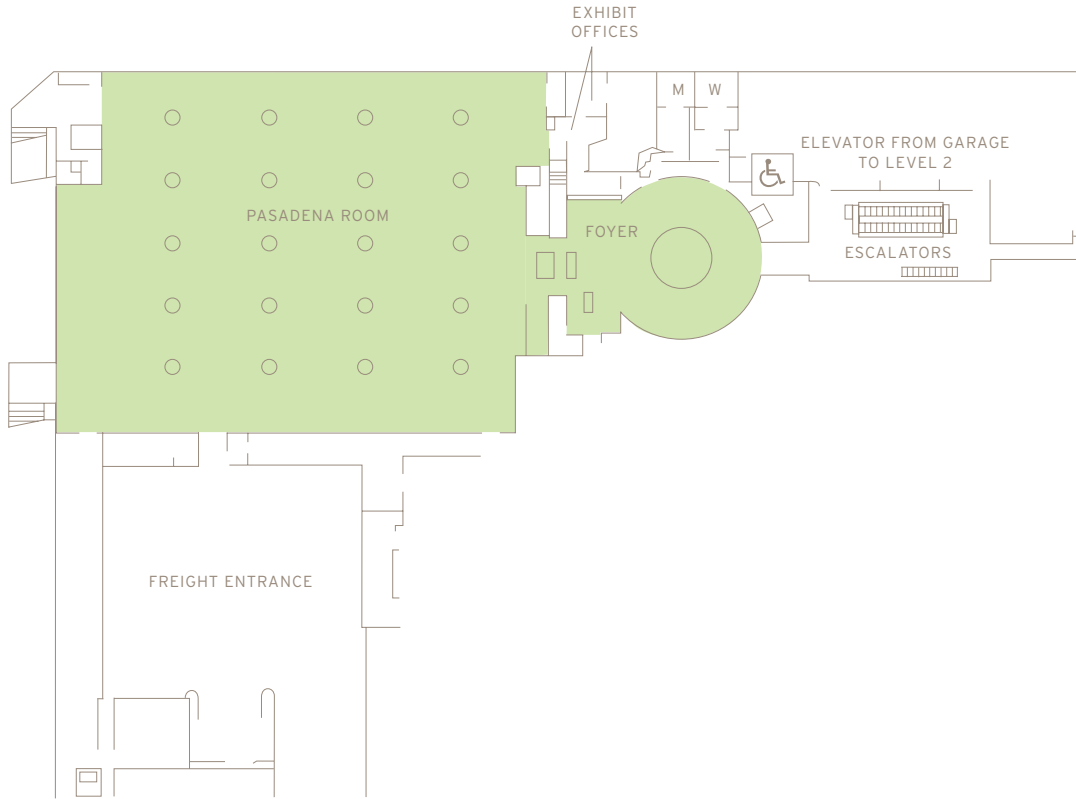

lobby level – function rooms

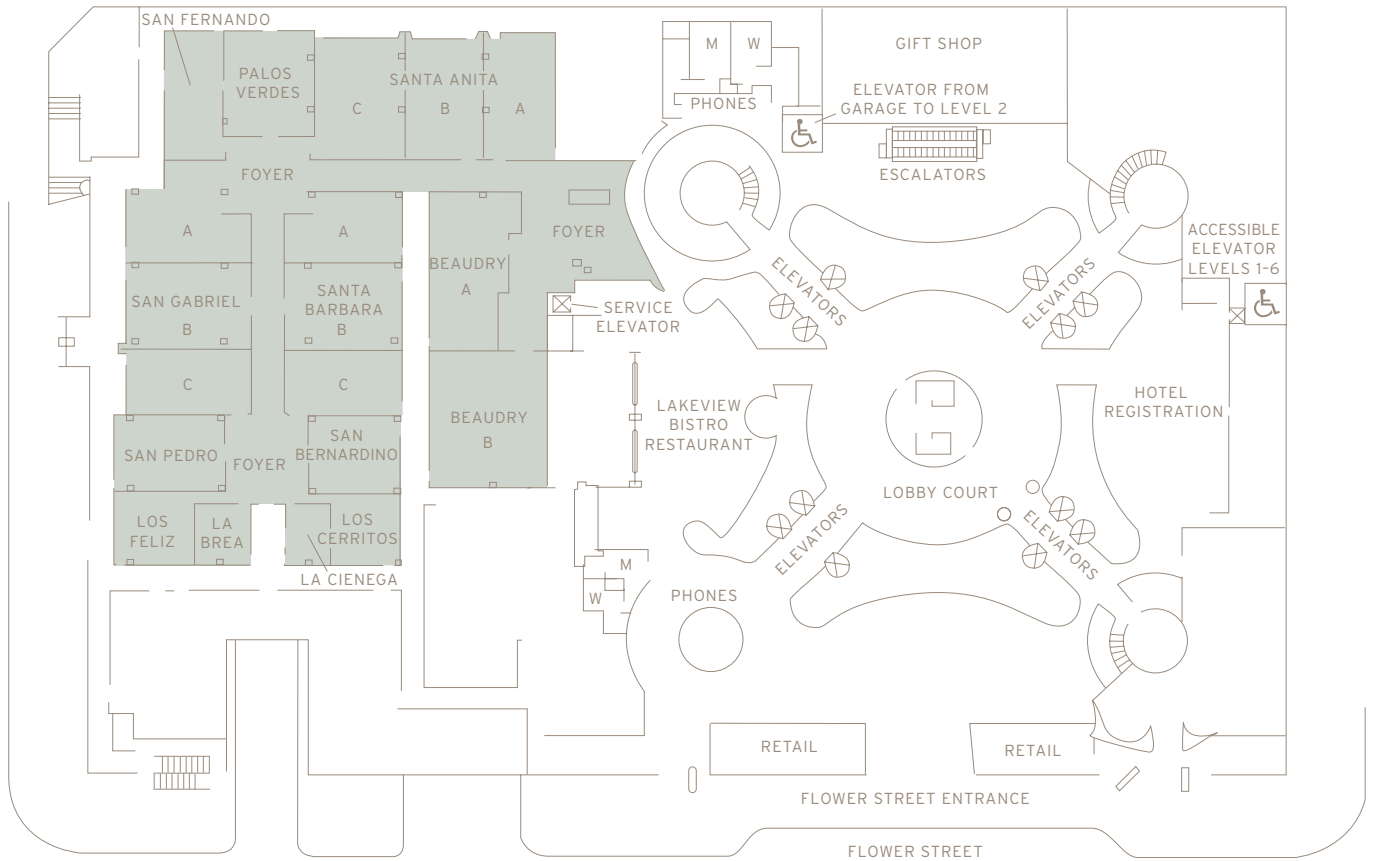

level 2 – california ballroom

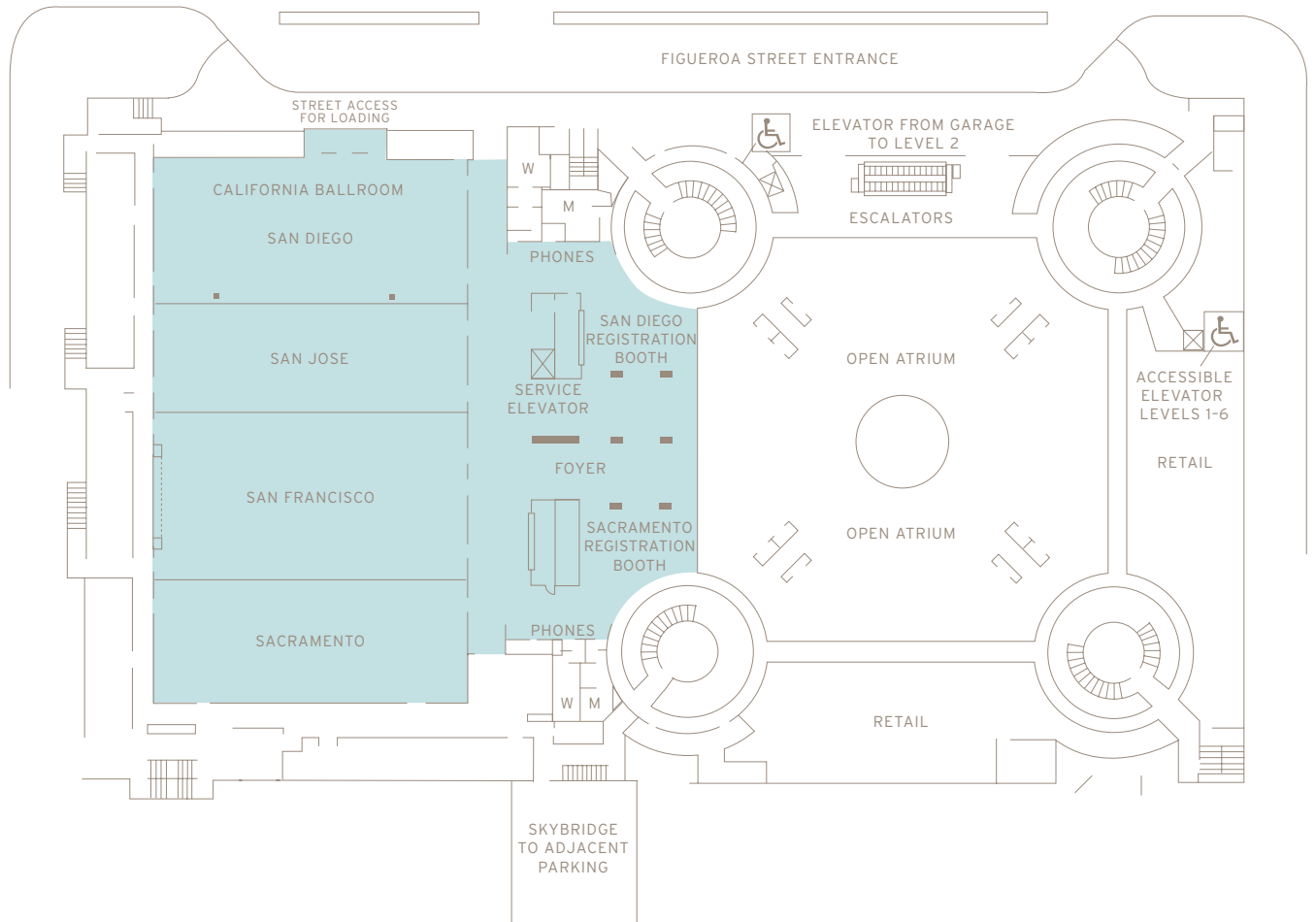

level 3 – catalina ballroom

